

WATERFOWL SURVEY FORM

DATE: 12/9/85

WEATHER INFORMATION

RIVER READING

Temp: 75°F Cloud Cover: 70% Percipitation: 0 101 MSL

TIME: Begin: 10:15 am End: 1:30 pm

RIVER MILES: PR/12 Flew 3 Transsects North to south

[illegible]

Total

All ducks SEEN on LEFT side - extremely hard to see with leaves still on trees.

SUMMARY PER MONTH OF 12/9/85

Species	Number	% of Total	River Miles	Ducks per Mile
Mallard	24	92		
Wood Duck	2	8		

Totals

26

Mallards - 480

Wood Duck - 40

520

Not a good representation of waterfowl present.
 Boat survey should give more accurate numbers
 on 12/11.

Overflow NWR

WATERFOWL SURVEY FORM

DATE: 12/10/85

WEATHER INFORMATION

RIVER READING

Temp: mid-60s (high) Cloud Cover: 7 Precipitation: 5 101.6' MSL (Approx).
 ↳ Overcast in a.m.; partly cloudy with very light shower in pm.

TIME:

Begin: 11:30 A End: 3:30 P (Included some)

Observer(s): Bill Parker + Bob Bridges (beaver control)

RIVER MILES: (see map)

Location	Mallard	Wood Duck	Other	Comments
<u>Creek</u>	22 35 7 3 8 15 50 14 4 2	4 5 15 50 25 2 15 2	6 W Teal - 20 W Teal - 30 Cooters - 4 6 W Teal 25	
North end of Billott's Slough)	12 4 125 * 200+ 20 8 10		GW Teal - 45 W Teal - 30 GW Teal - 4	

Total

541 (+)

119

79

=

739+

591

119

79

=

789

* Estimated 250

SUMMARY PER MONTH OF 12/10/85

Species	Number	% of Total	River Miles	Ducks per Mile
MALLARD	591	74.9	8.64	68.4
WOOD DUCK	119	15.1	"	13.8
G.W. TEAL	45	5.7	"	5.2
GLADWALL	4	0.5	"	0.5
UNKNOWN	30	3.8	"	3.5

Totals 789 100 8.64 91.4

Estimates based on 15% survey Approximately 5300 Ducks Total

SPP.	% Total	Number
Mallard	74.9	3970
Wood Duck	15.1	800
G.W. TEAL	5.7	302
GLADWALL	0.5	27
UNKNOWN	3.8	201
Total		<u>5300</u>

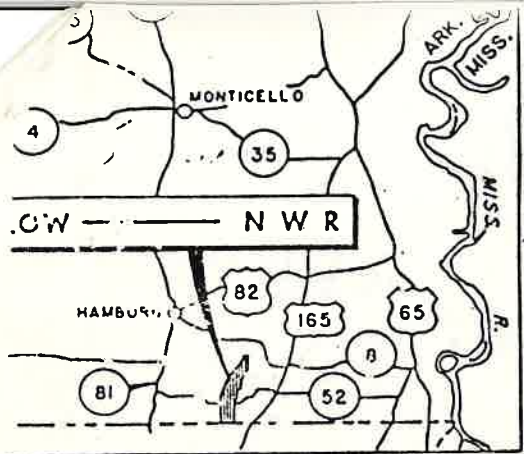

Waterfowl Survey - 12/10/85
12/85
(Parker & Bridges)

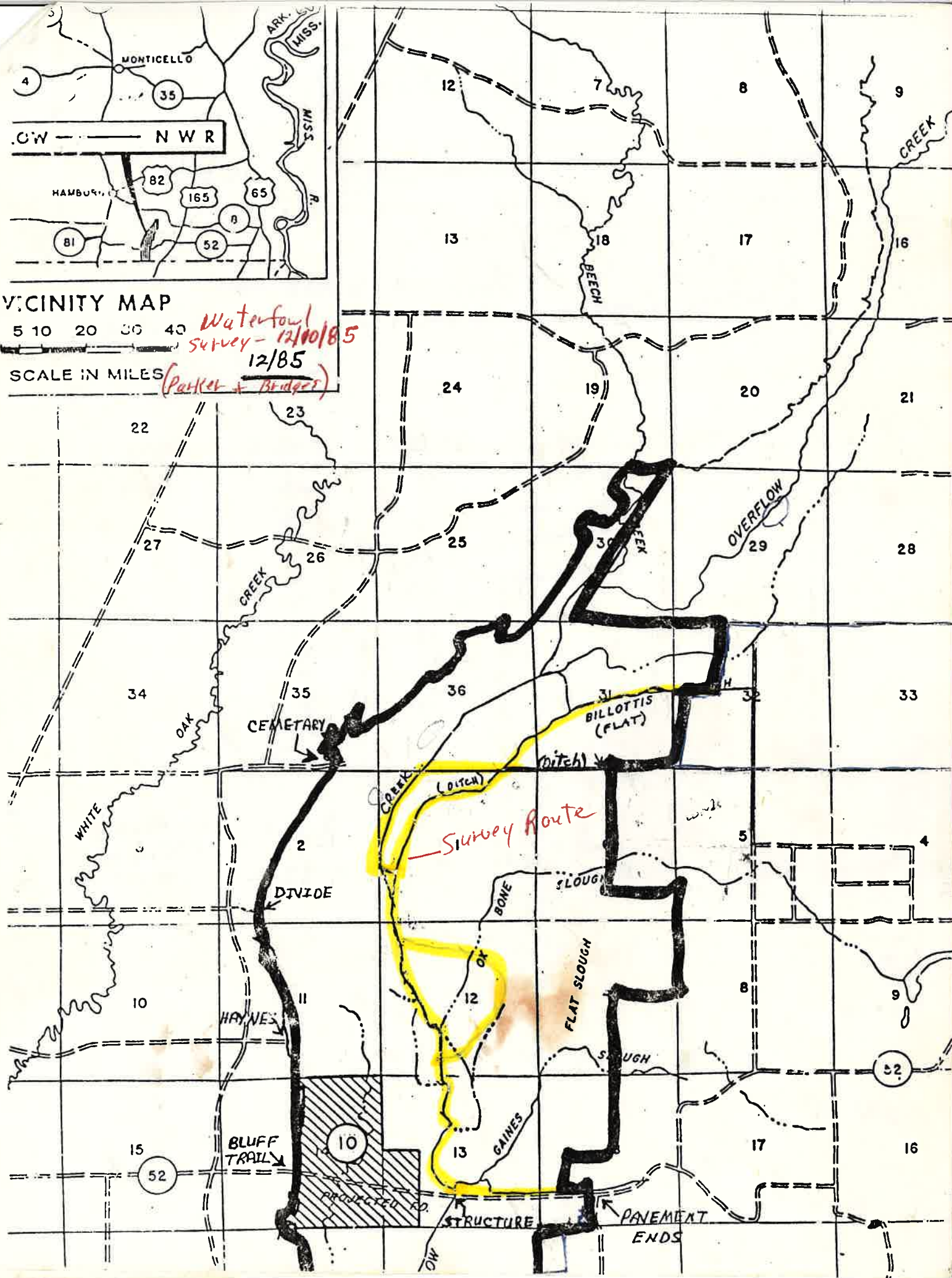

+ Beaver
Waterfowl Summary - Overflows
4-7-87 (4:30-7:00P)

- B W teal - 200
- 6W teal - 50
- shoveller - 100
- wood duck - 30
- mallard - 15
- pintail - 5

Killed two adult beaver
plus one adult nutria - 2 state
hours. R.B.